



# RECONFIGURING FUTURE OF RESORT CITIES CESIS



*“EVERY MORNING WE HAVE TWO CHOICES: CONTINUE TO  
SLEEP WITH OUR DREAMS, OR WAKE UP AND CHASE THEM”*

CARMELO ANTHONY





*'I DON'T BELIEVE ARCHITECTURE HAS TO SPEAK TOO MUCH.  
IT SHOULD REMAIN SILENT AND LET NATURE IN THE GUISE OF  
SUNLIGHT AND WIND'*

TADAO ANDO



## RESORT NOWADAYS

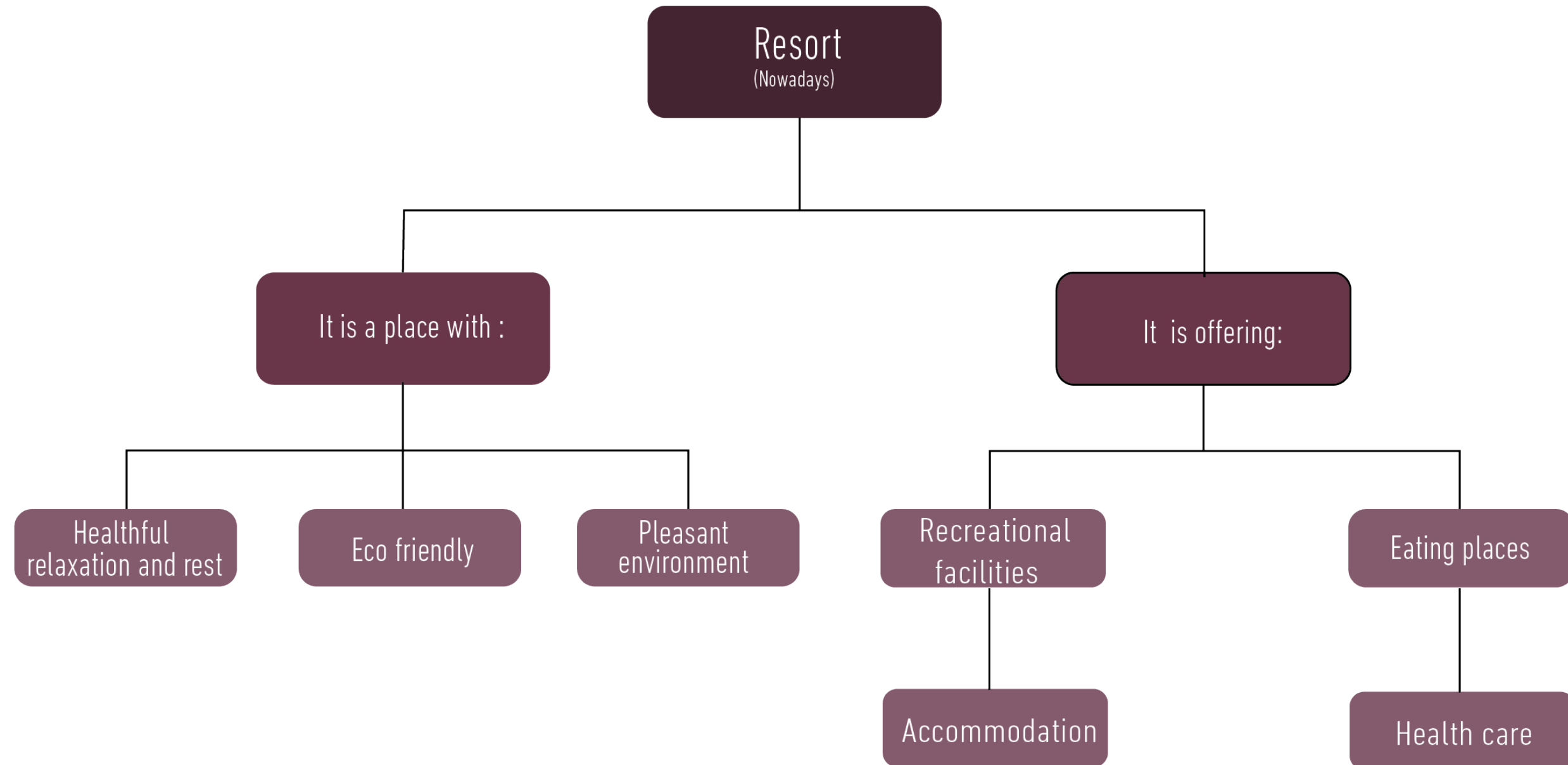



*"ONE CANNOT MAKE ARCHITECTURE WITHOUT STUDYING  
THE CONDITION OF LIFE IN THE CITY."*

ALDO ROSI



## GREEN PARTS OF CESIS



## 3 ELEMENTS OF CESIS





# ACTIVITIES BY SEASON

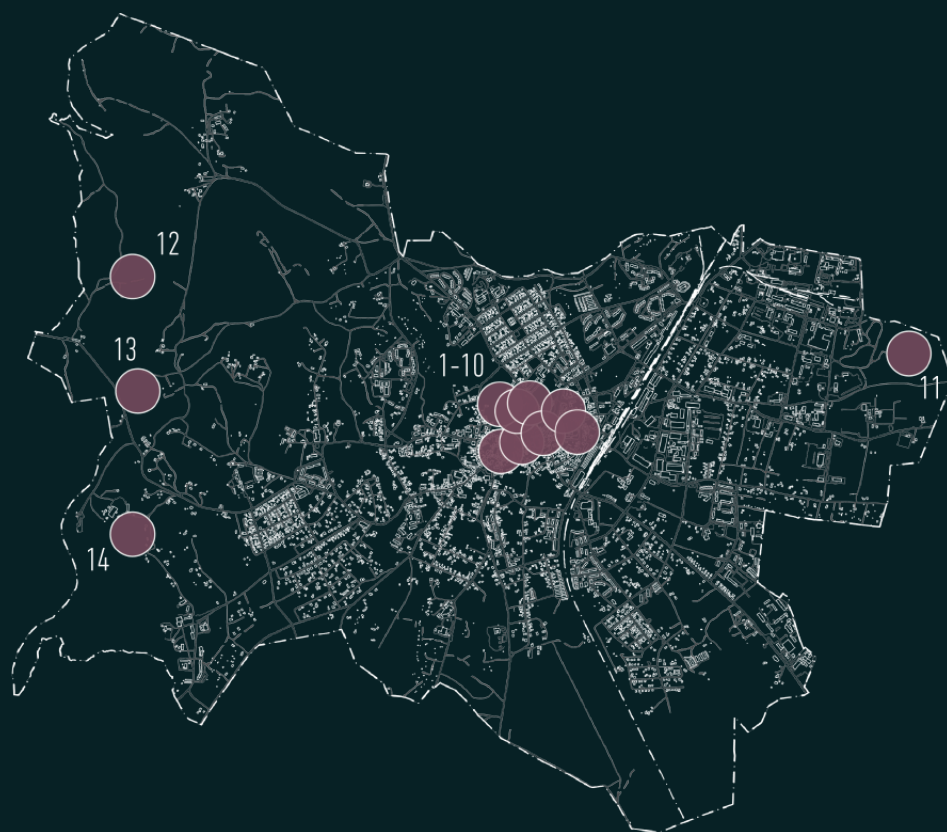

## SUMMER ACTIVITIES

1. Cēsis Castle complex
2. Concert Hall "Cēsis"
3. Festivals
4. "Markets"
5. Velotourism
6. Craft workshops
7. Cesis exhibition house



## WINTER ACTIVITIES

8. World Latvian Art Centre
9. Brewery Brūzis
10. Old town
11. Active recreation park "Karjers"
12. Sarkanās klintis
13. Gauja watertourism
14. Forest trails
15. Žagarkalns

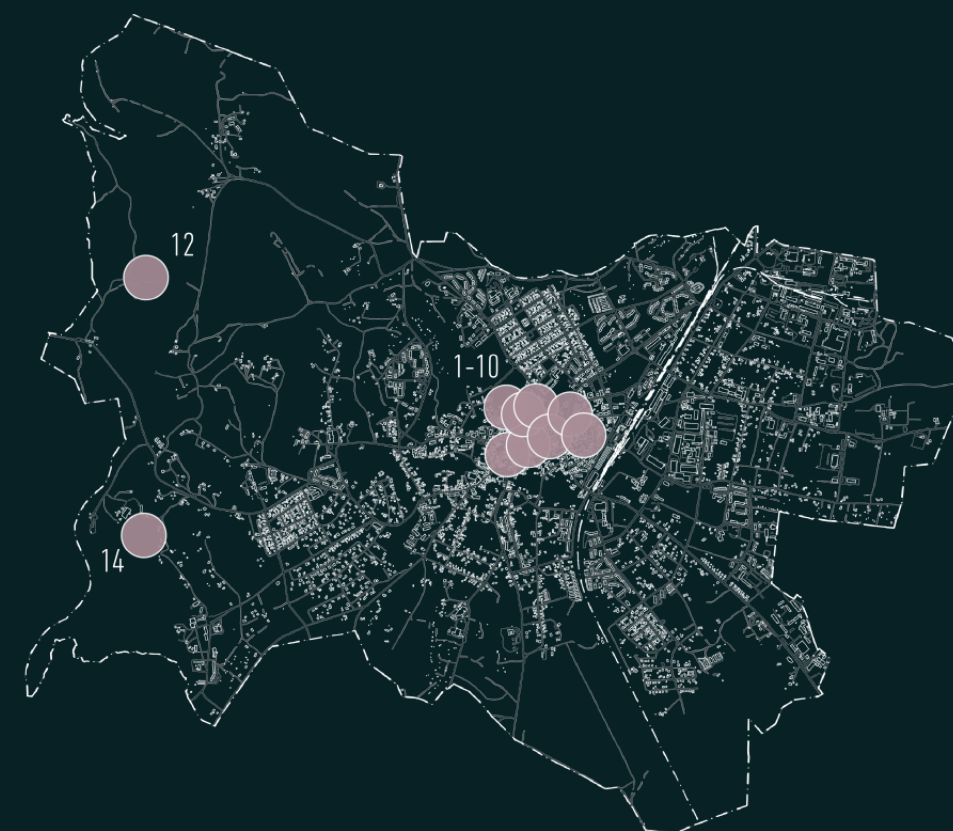

## AUTUMN AND SPRING







# VISION

## BREAK BORDERS

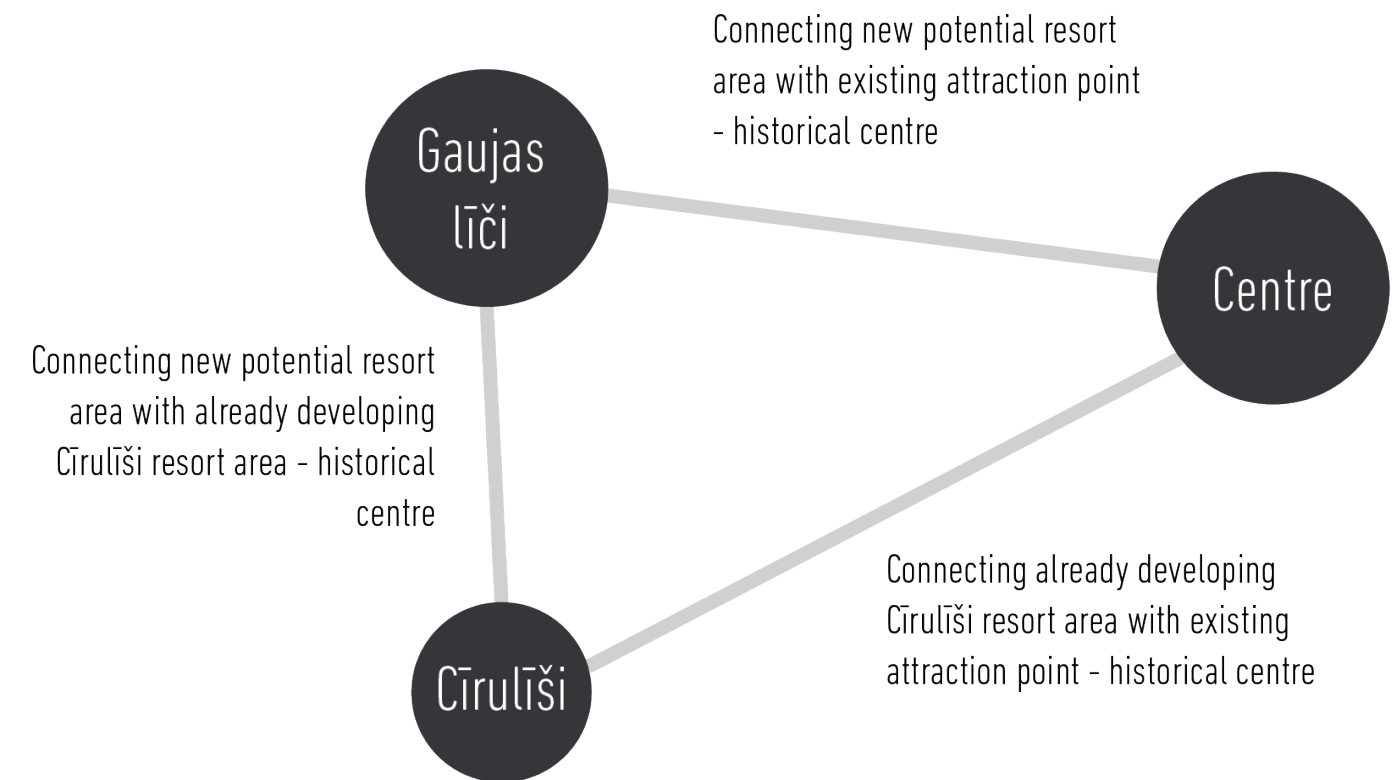







# ACTIONS REQUIRED

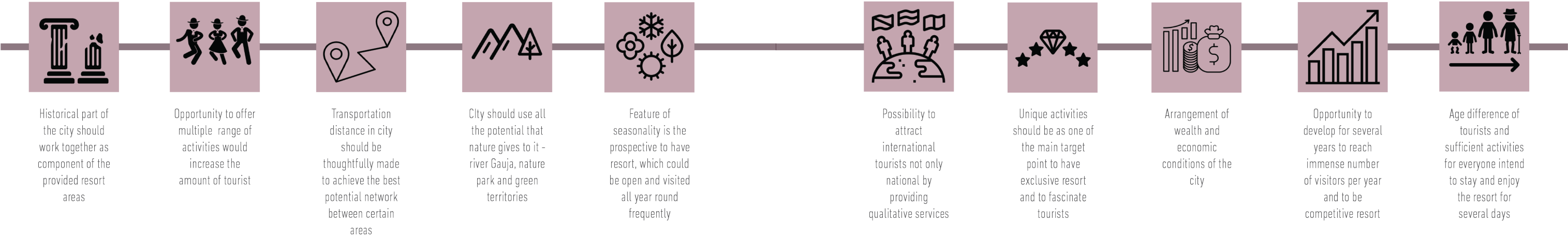



## MONITORING AND EVALUATING RESULTS

Forest usage area  
Path intersection

Potential place to use the river

Forest usage area

Existing wooden building in  
Vītola street 9

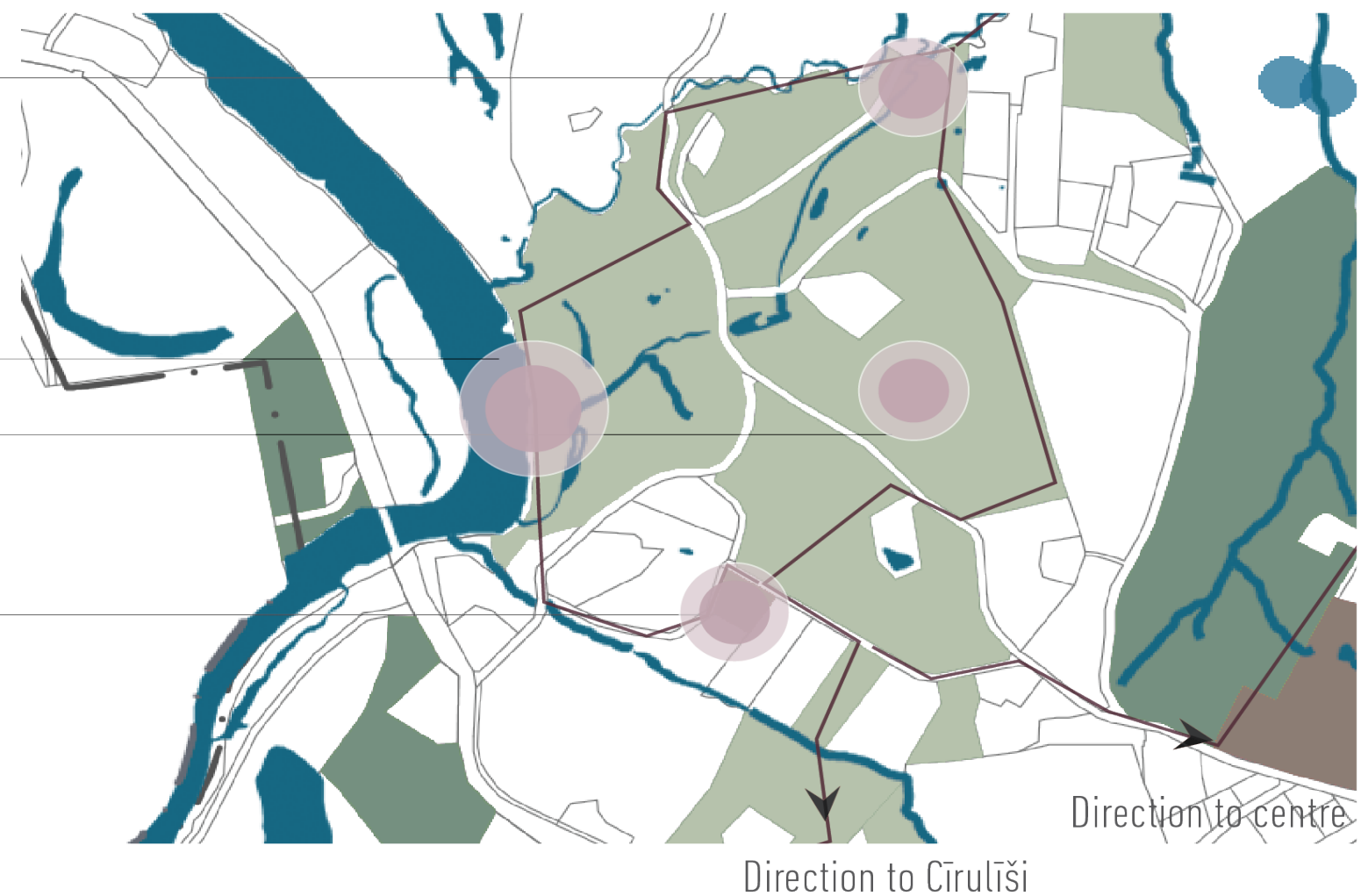

Potential areas



Potential pathways







# BREAKING BORDERS

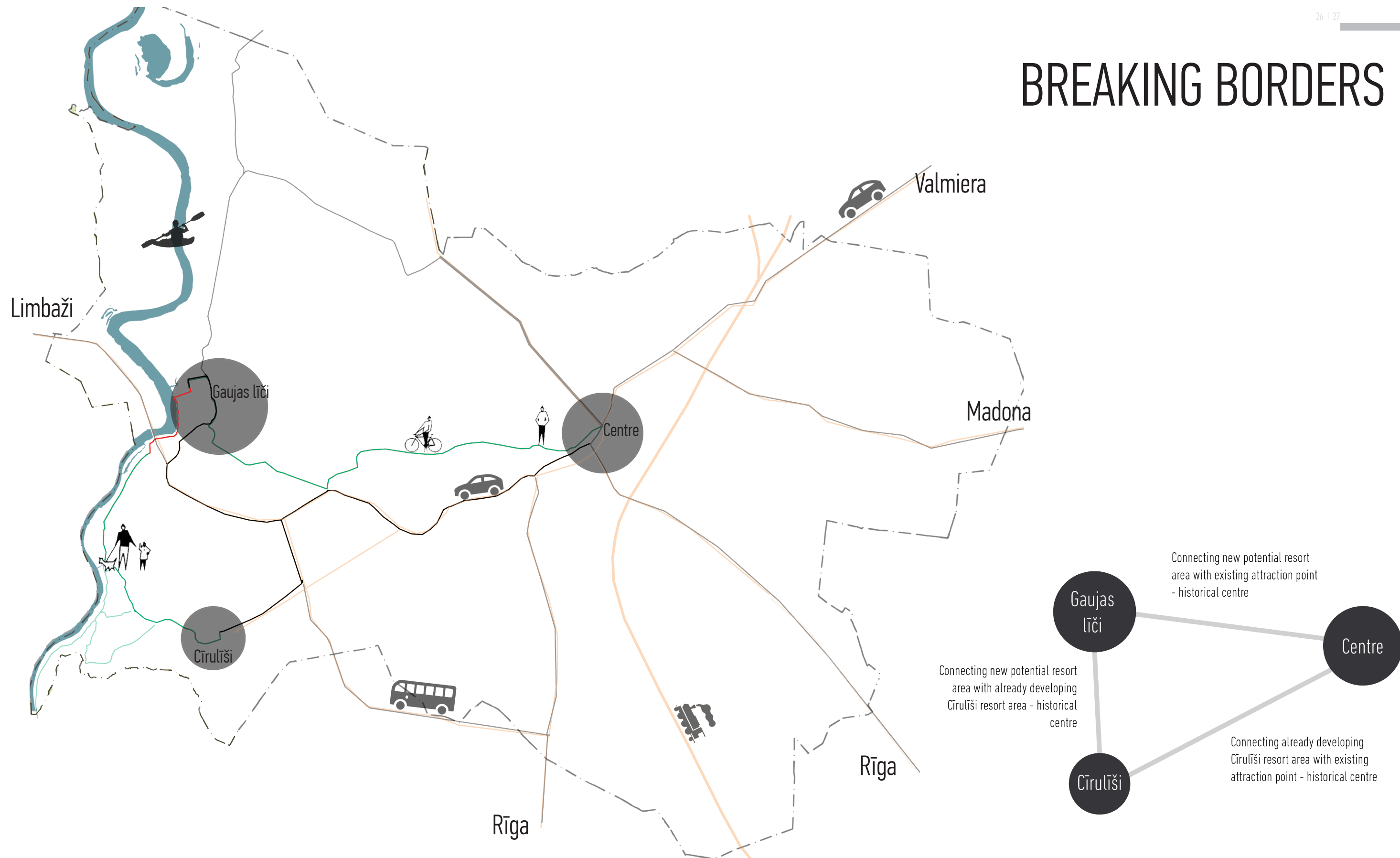



# VISION

NIGHT TIME



DAY TIME





## ACTIVITY TYPES

### EXTREME

Night hiking  
Night shows  
Bubble tent

### ACTIVE

Cycling  
Canoe  
Hiking

### CALM

Walking  
Relaxing in tub  
Picnic place  
Scenery enjoyment

## TARGET AUDIENCE

### NATURE

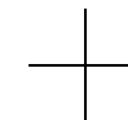
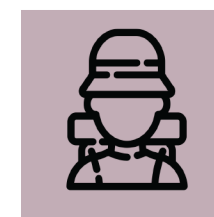

### LOCALS



### NETWORKING

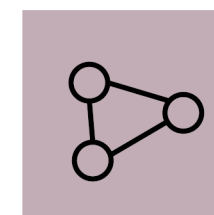



## ACTIONS REQUIRED

1. WOODEN PATH BESIDES RIVER
2. STAGE ON WATER
3. VIEW PLATFORM WALKWAY
4. SITTING AREA
5. BOAT PIER
6. PARKING
7. ADMINISTRATION BUILDING
8. NATURE'S HOT TUB
9. BUBBLE TENT
10. ENCLOSED STRUCTURE BRIDGE
11. MULTI PURPOSE STAGE
12. PICNIC PLACE
13. MIRROR INSTALLATION
14. WORKSHOP BUILDING





## ENCLOSED STRUCTURE BRIDGE

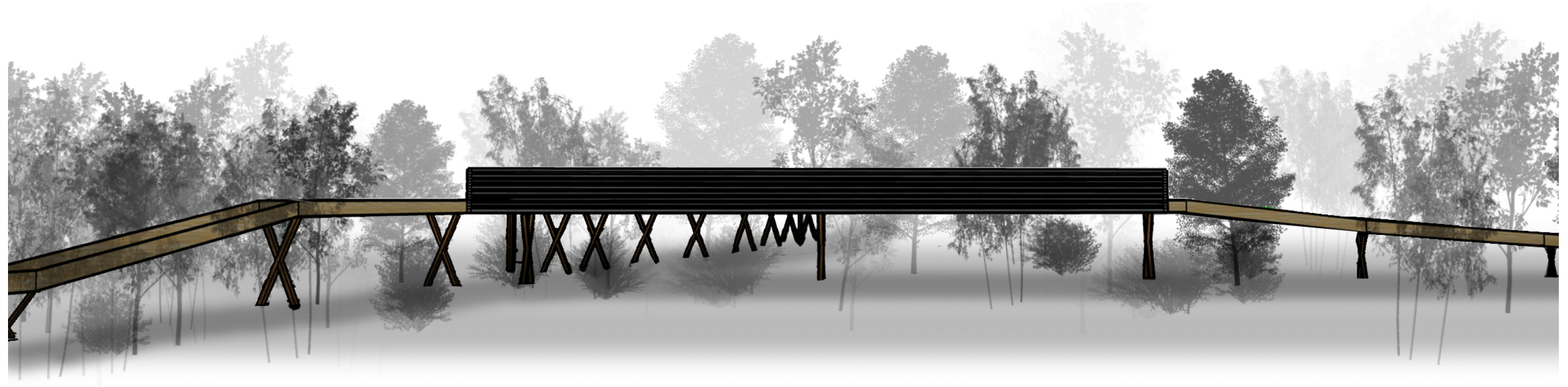

## VIEW PLATFORM WALKWAY

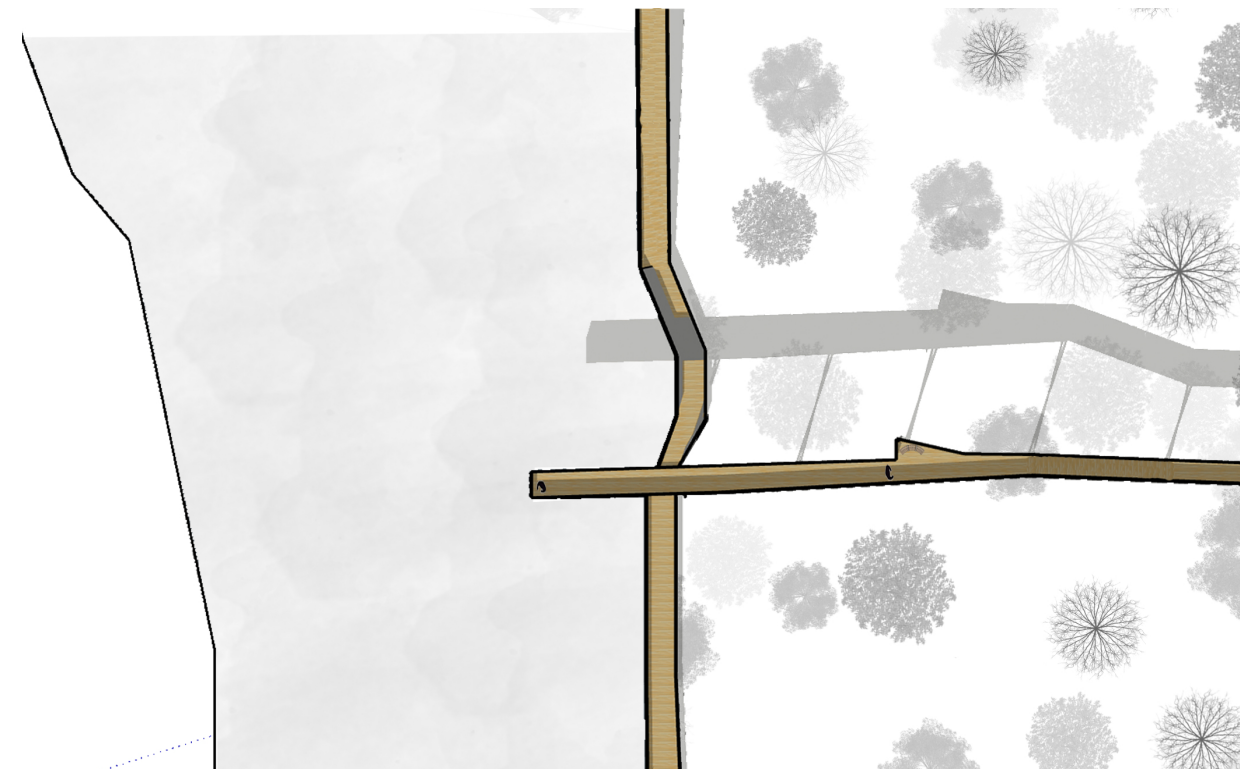
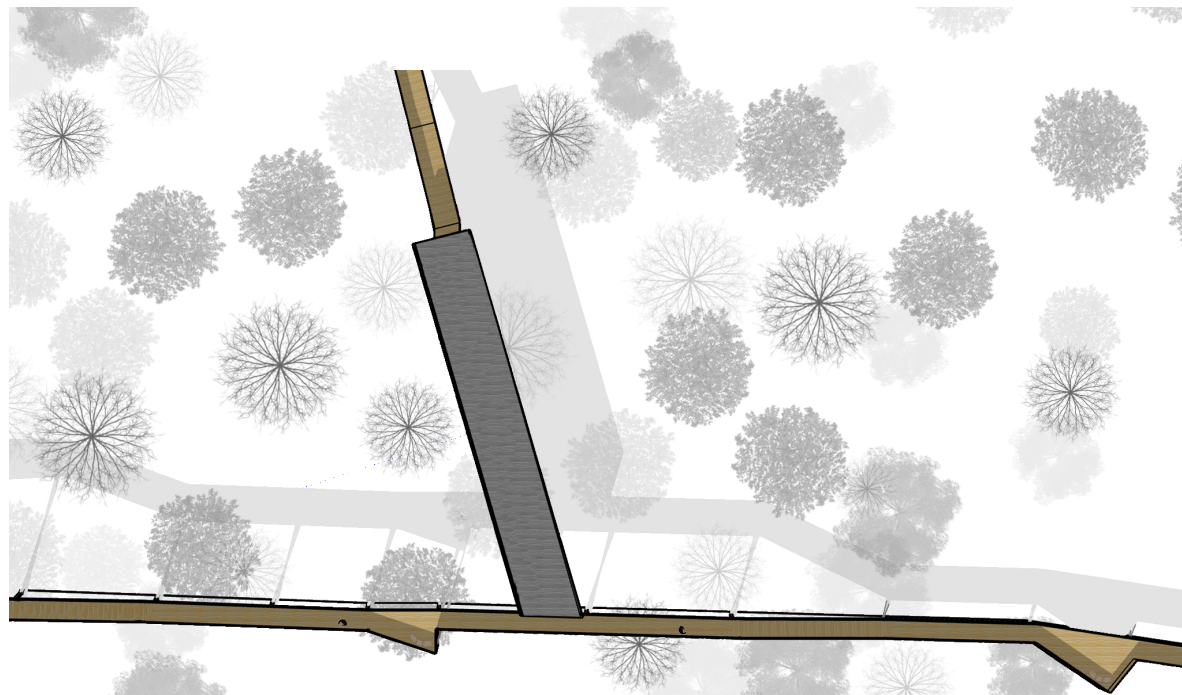



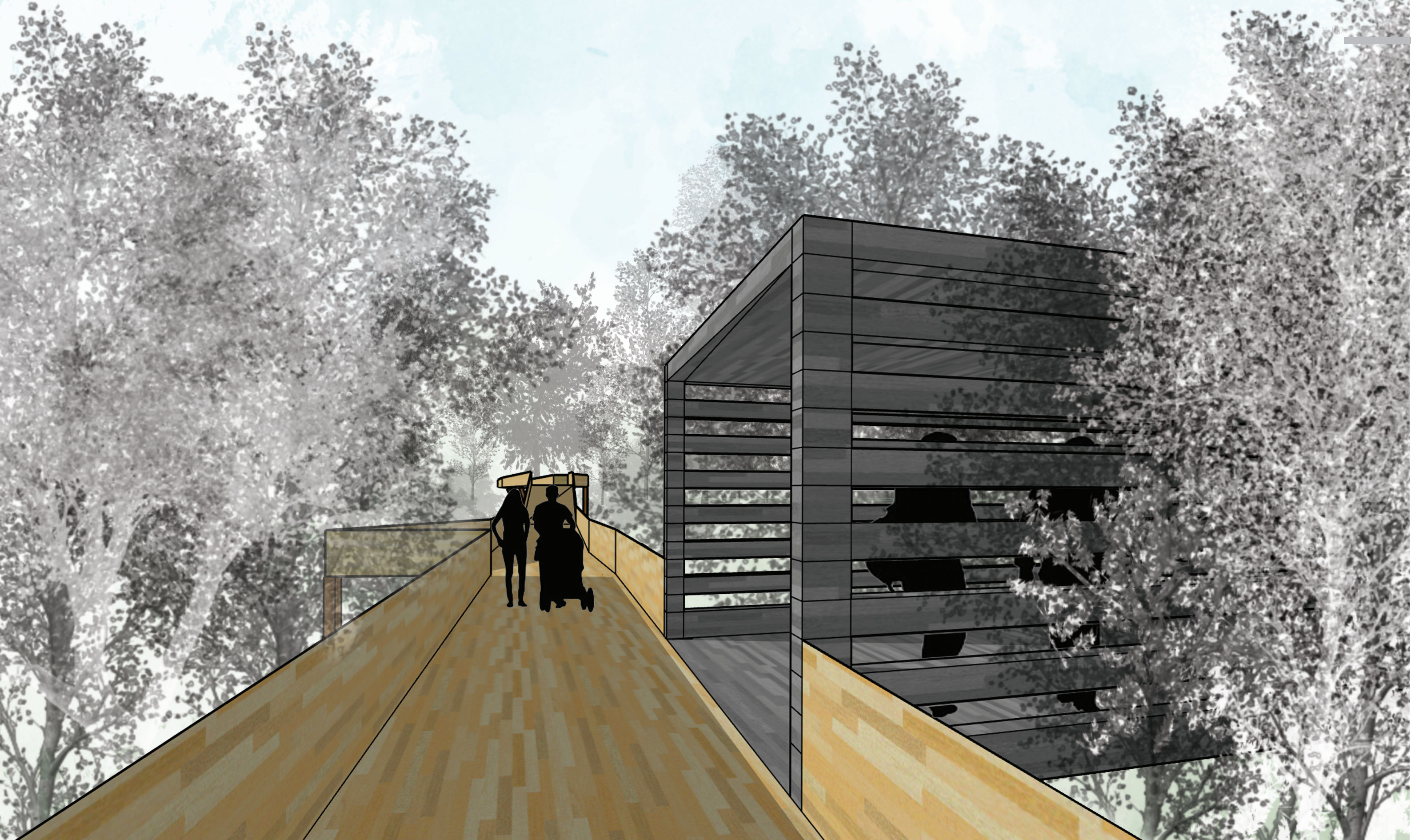



## WOODEN PATH BESIDE RIVER

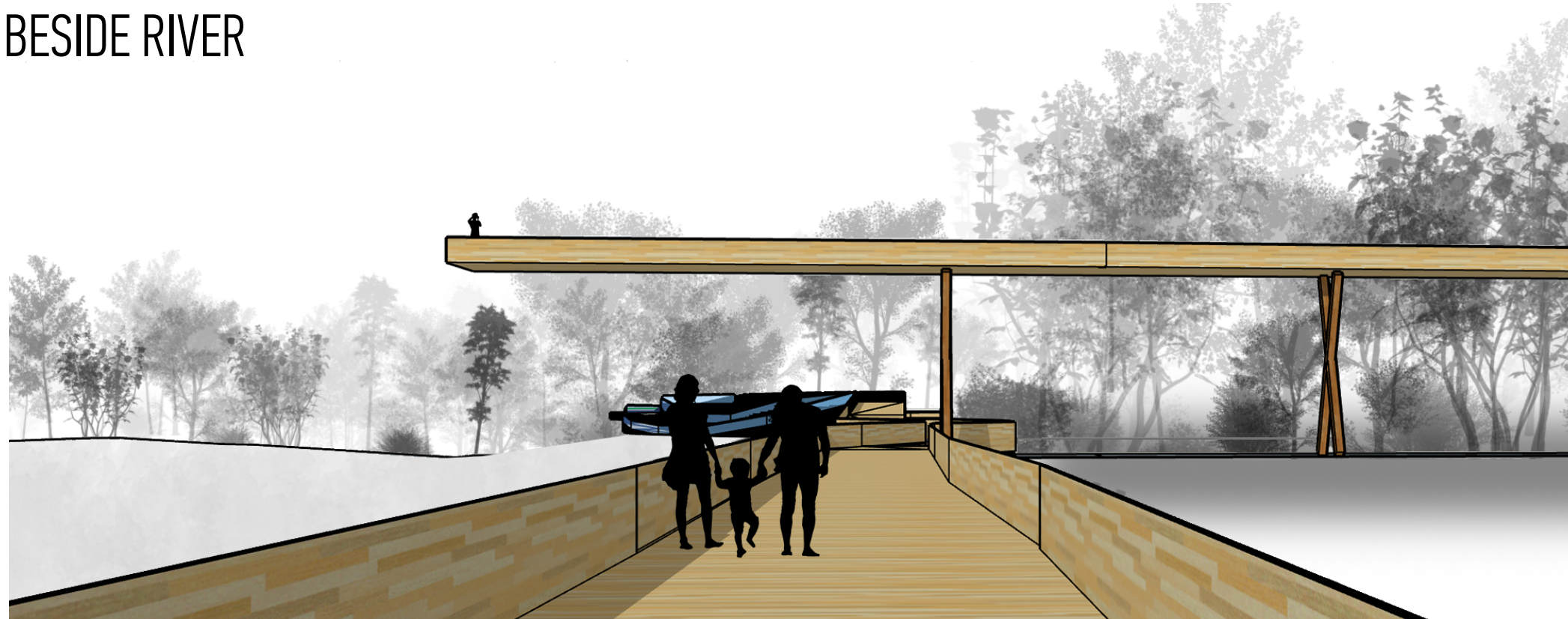

## STAGE ON WATER

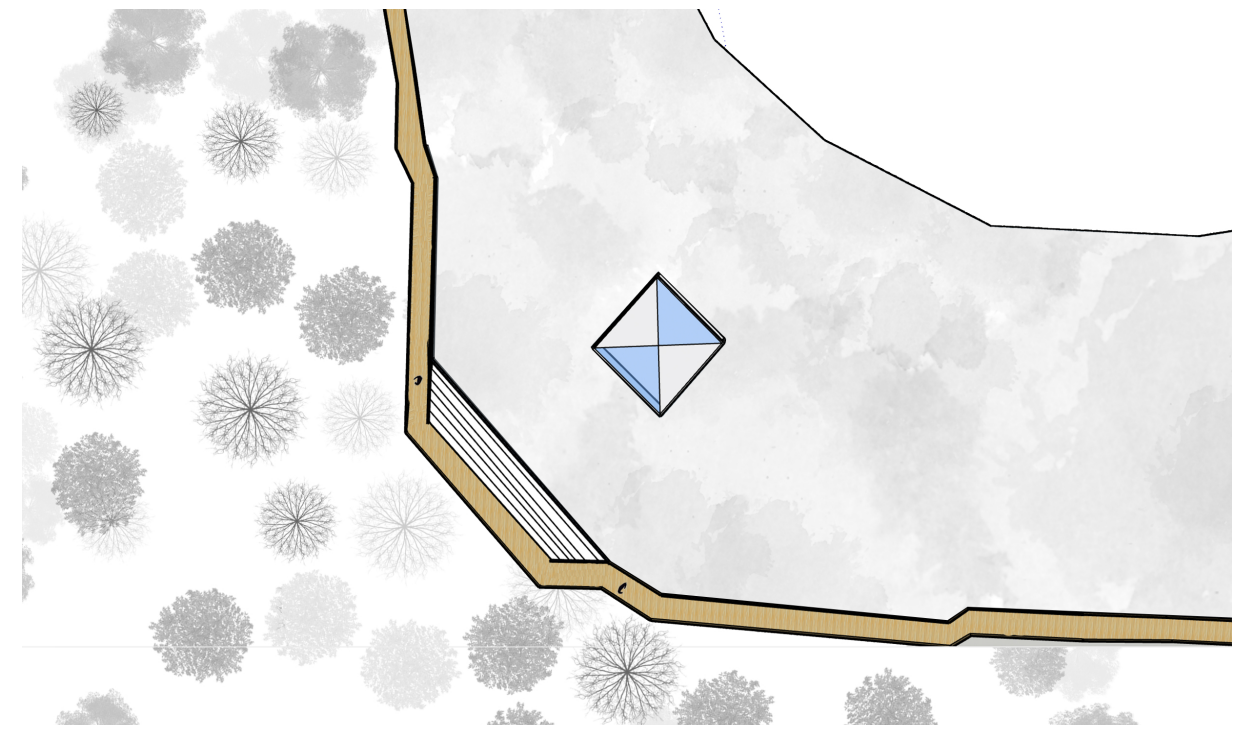
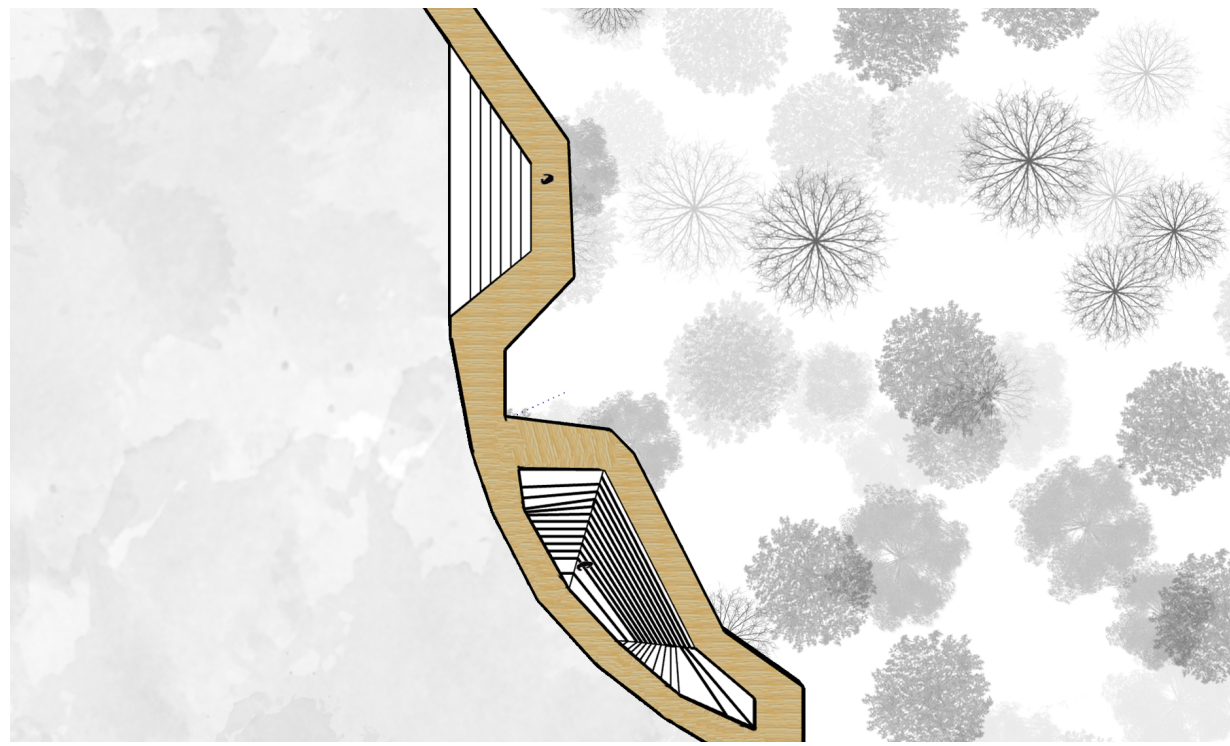



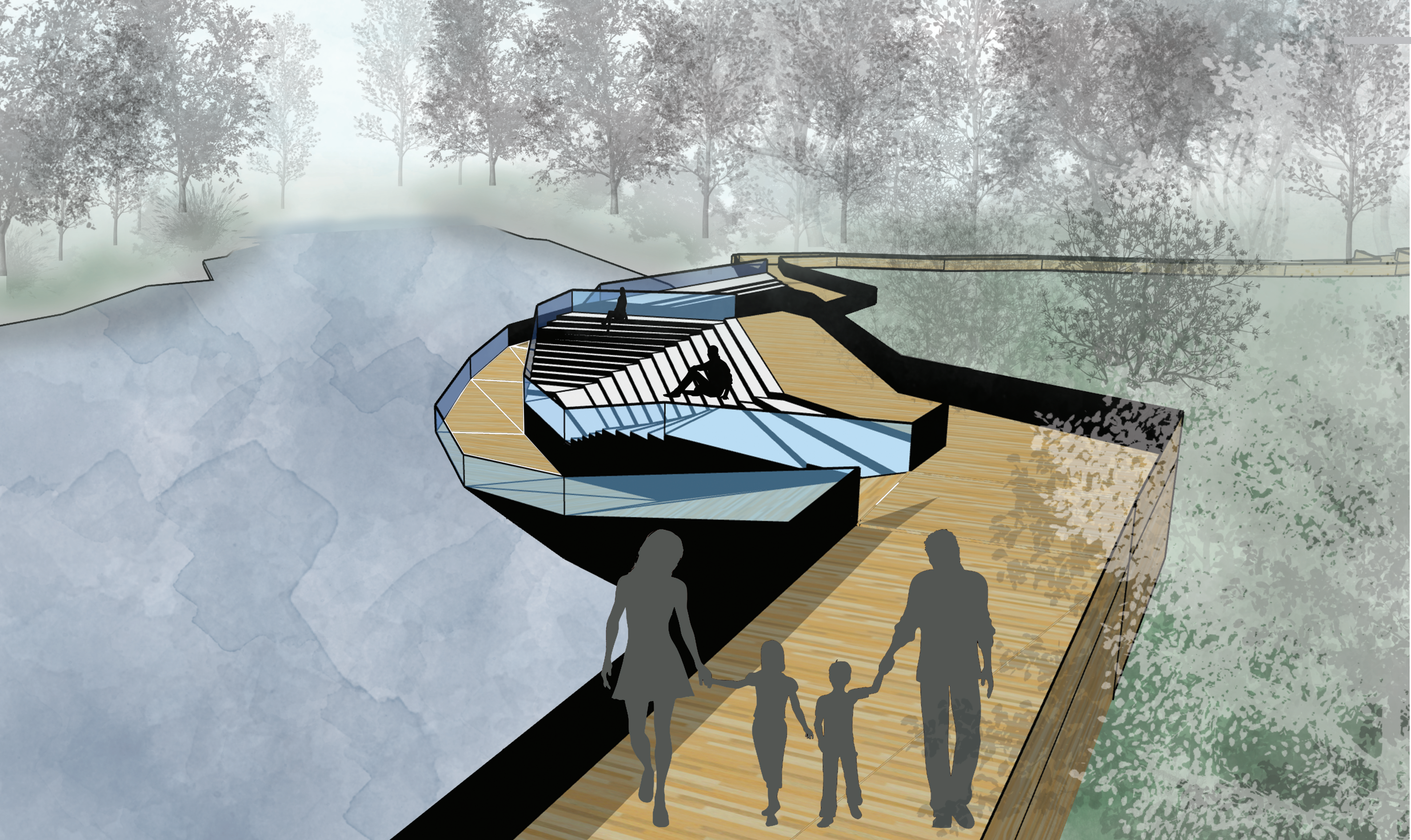



## BUBBLE TENT

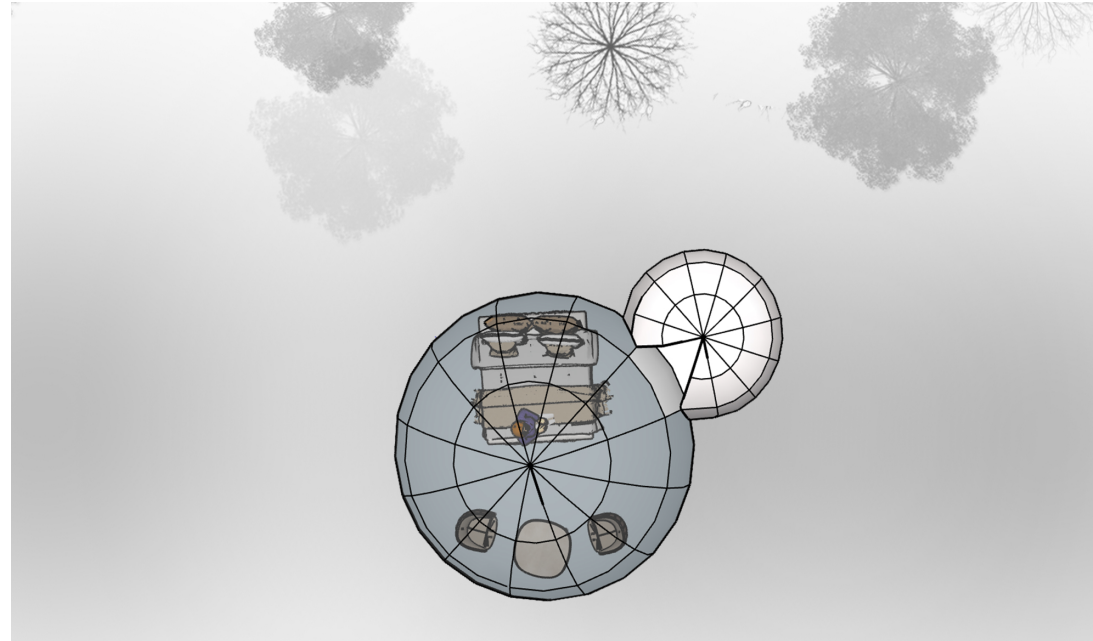

## MULTI PURPOSE STAGE

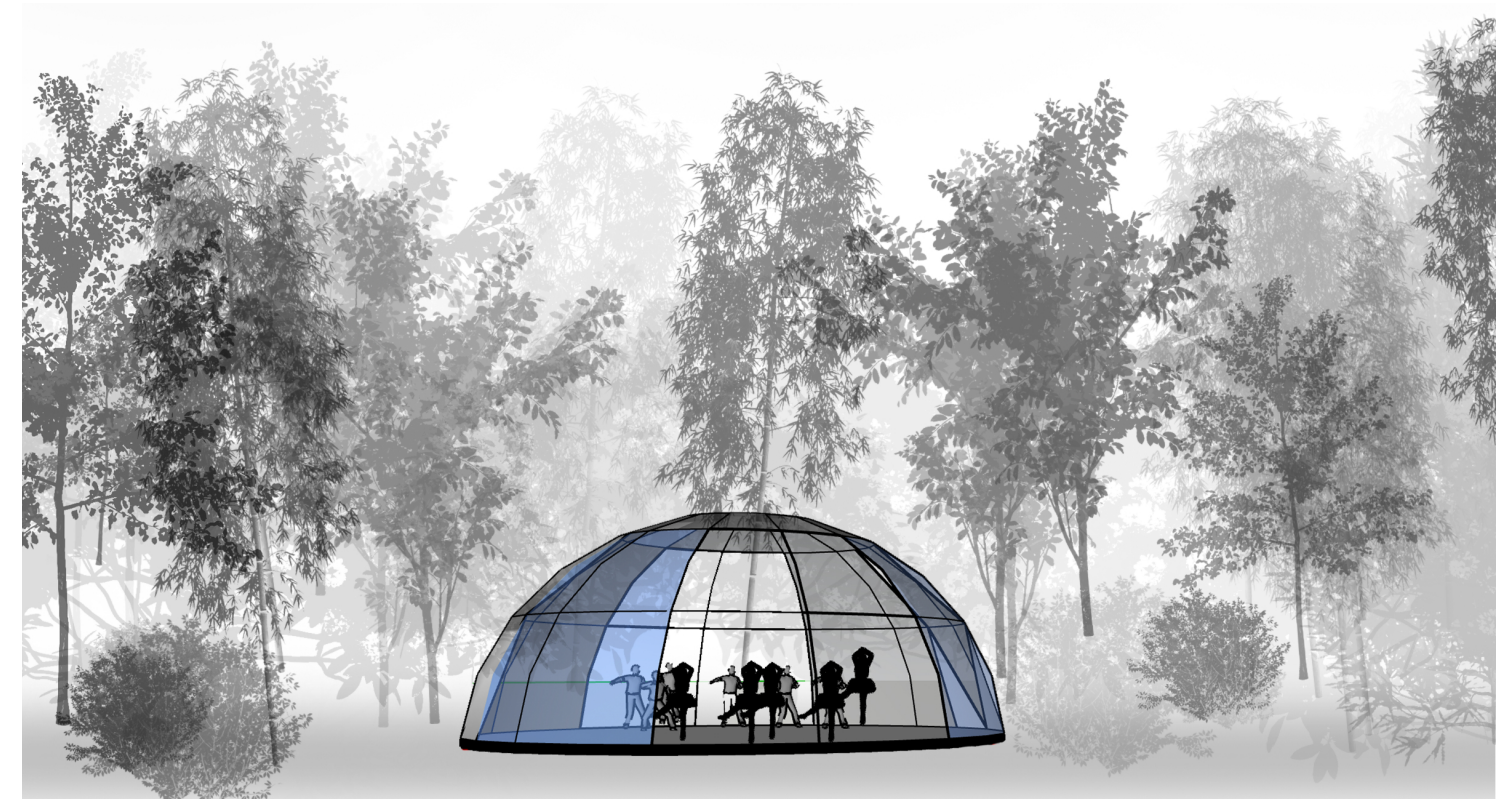
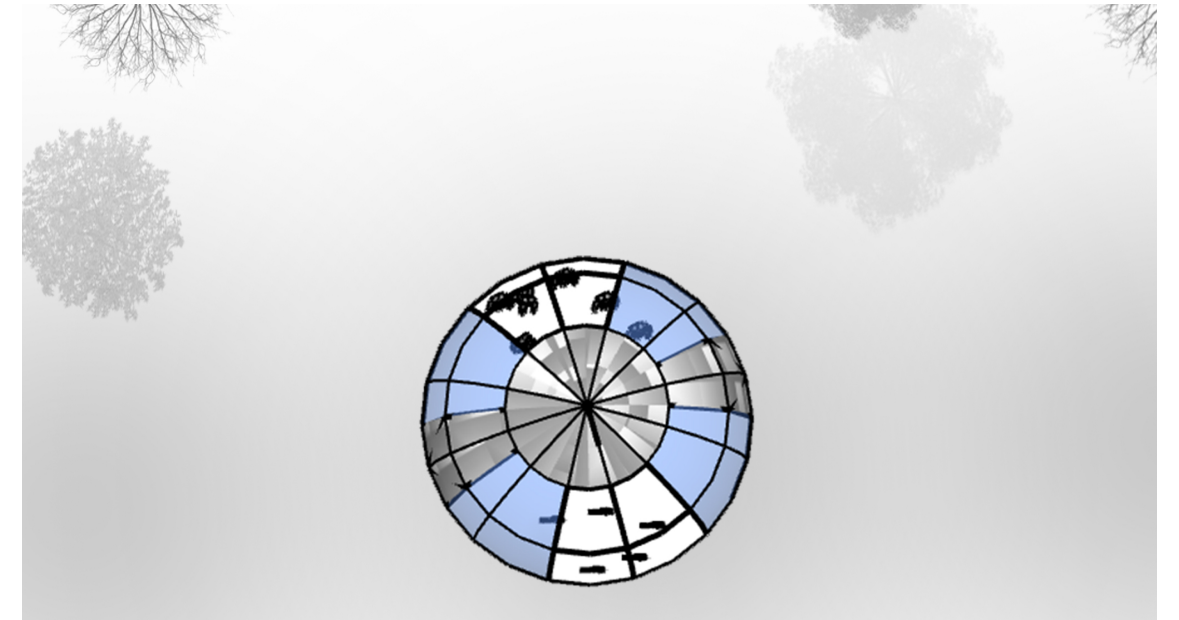



## PICNIC PLACE

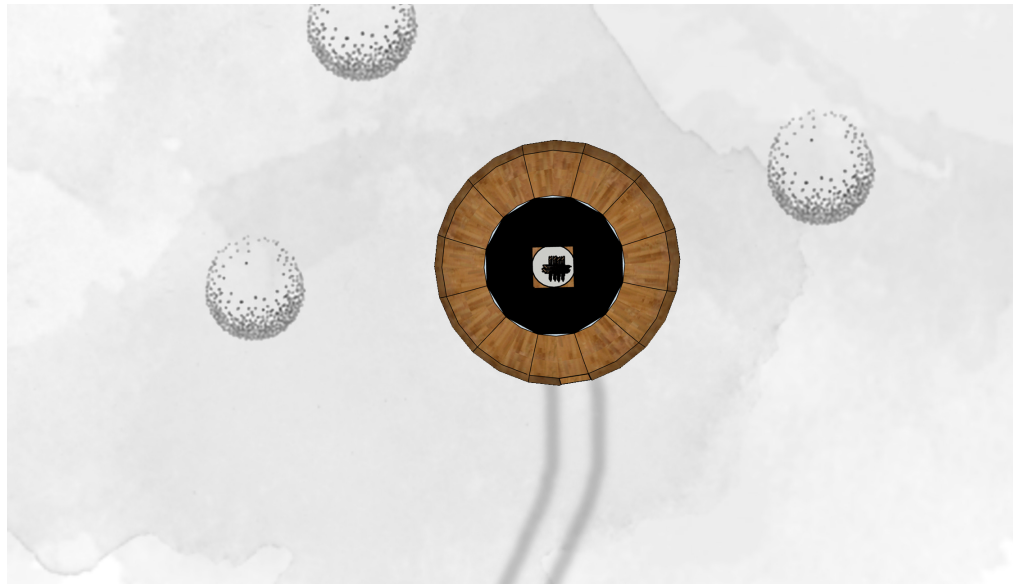

## NATURE'S HOT TUB





## MIRROR INSTALLATION

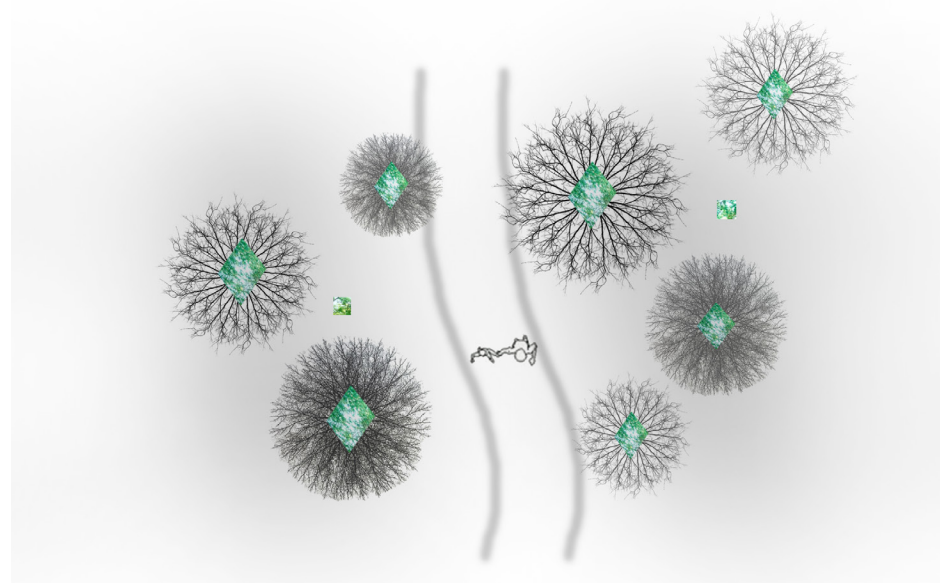

## WORKSHOP





# ELEMENTS OF GAUJAS LĪČI

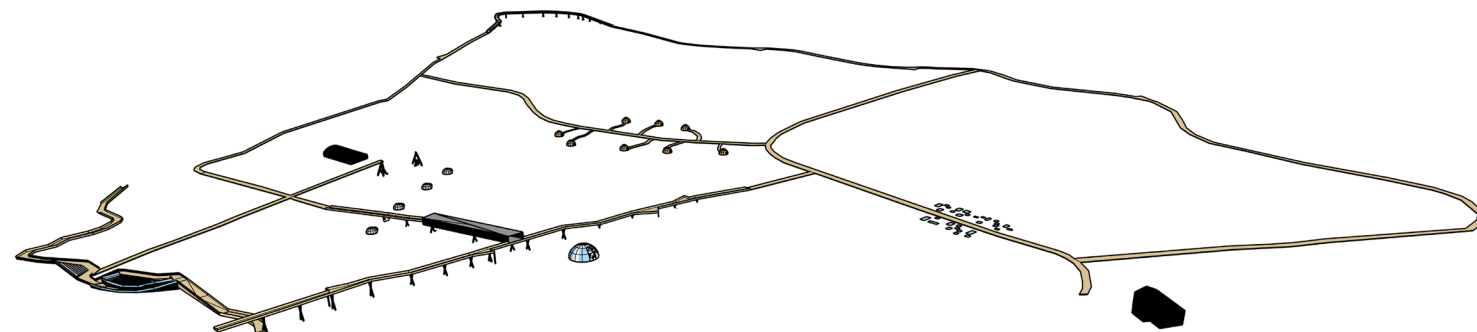

NEWLY CREATED PATHS AND ACTIVITY OBJECTS

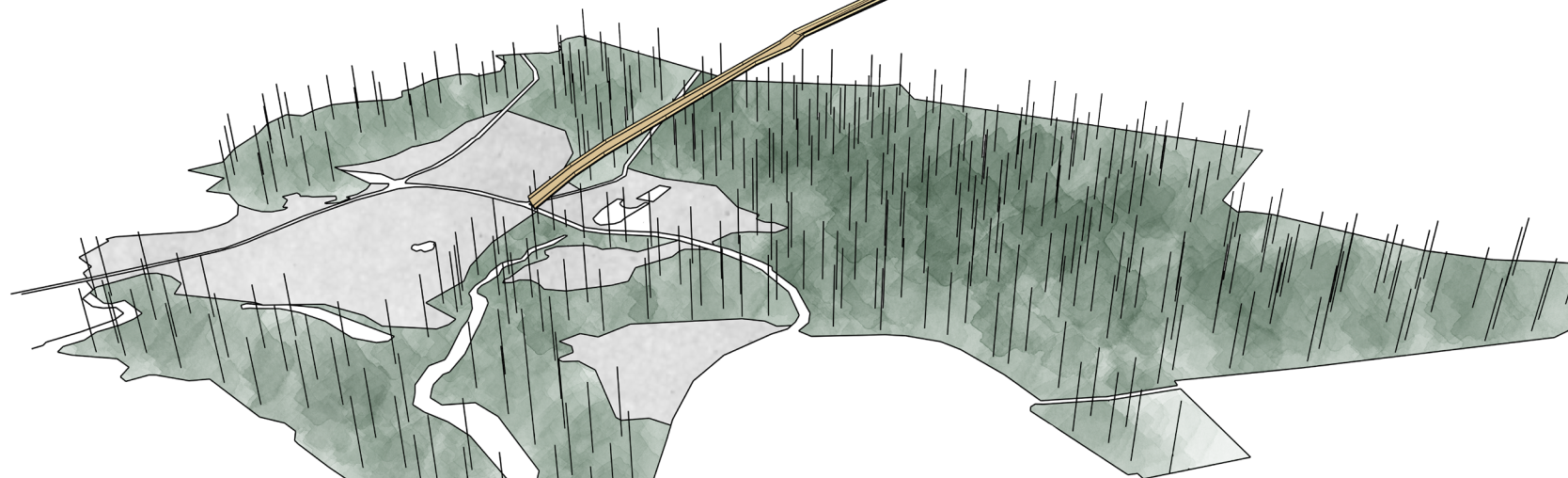

EXISTING ROADS AND NATURE TERRITORIES

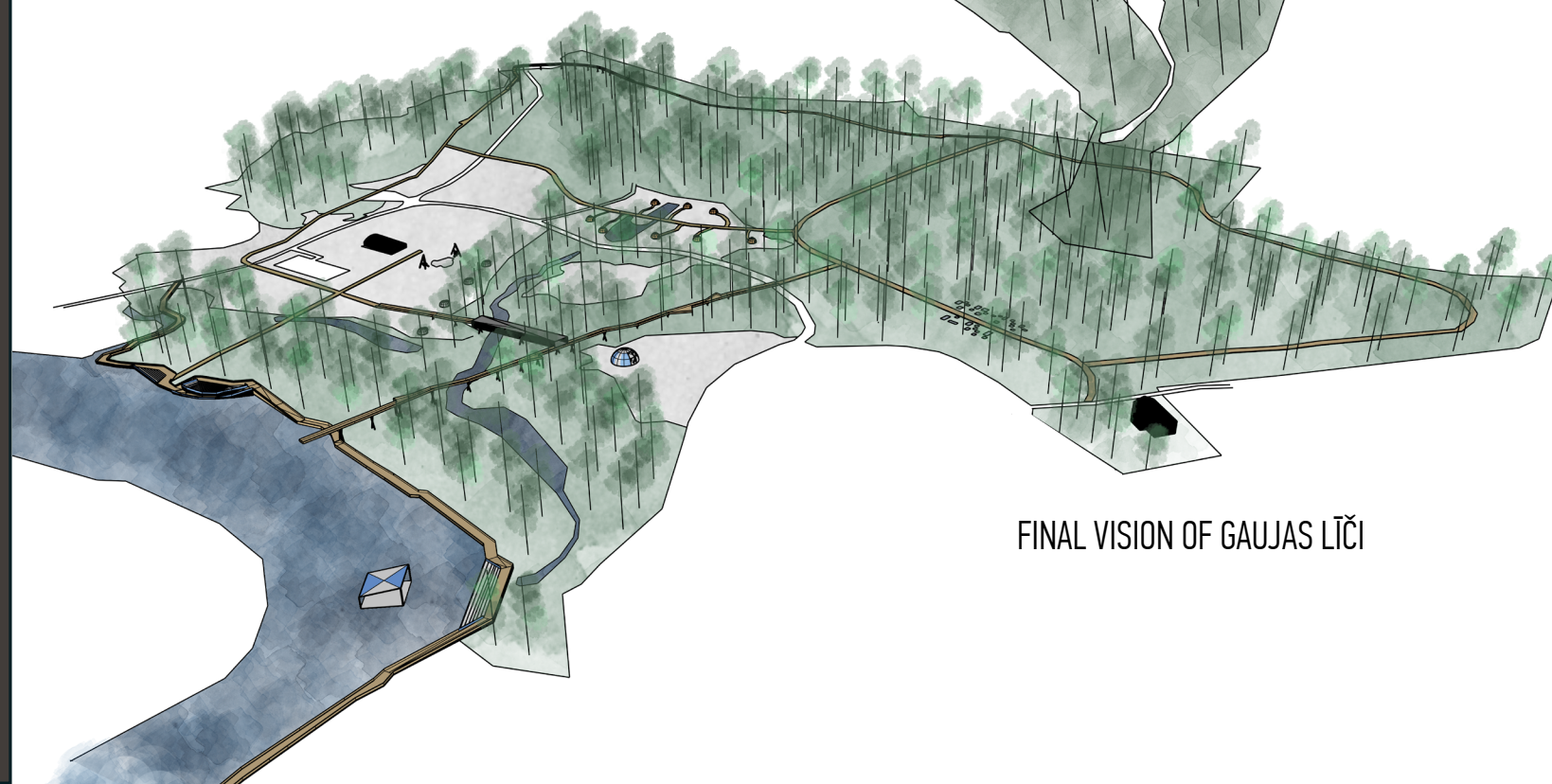

FINAL VISION OF GAUJAS LĪČI



# CONCLUSION

*WHY WE ARE BREAKING BORDERS?*

*HOW WE ARE BREAKING BORDERS?*

*WHY DOES IT MATTER TO BREAK BORDERS?*



*"SIMPLICITY IS THE ULTIMATE SOPHISTICATION"*